

## G28000 / G28500 Stainless Steel 316 Butt Hinge

### Features

- High corrosion resistance

### Material

- Stainless steel 316, polished

### Notes

- Recommended for use in pairs
- Recommended door dimensions in the below table are based on usage of two hinges for one door

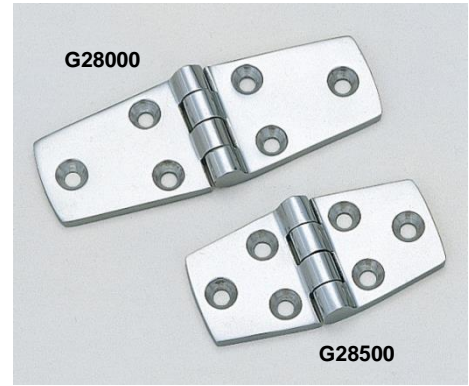
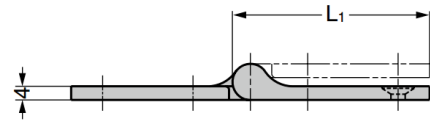
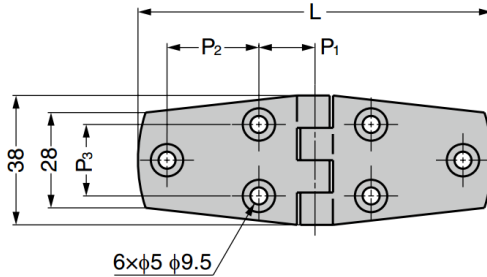

Part No.	L	L <sub>1</sub>	P <sub>1</sub>	P <sub>2</sub>	P <sub>3</sub>	Door Width	Door Height	Door Thickness	Load Capacity (per pair)	
G28500	74	42	13	17	20	Max. 450	Max. 700	Max. 21	167 N	17 kg
G28000	104	57	16.5	27	21					

## G27800 / G27000 Stainless Steel 316 Butt Hinge

### Features

- High corrosion resistance

### Material

- Stainless steel 316, polished

### Notes

- Recommended for use in pairs
- Recommended door dimensions in the below table are based on usage of two hinges for one door

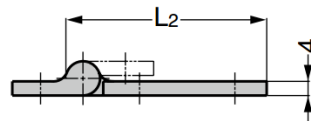
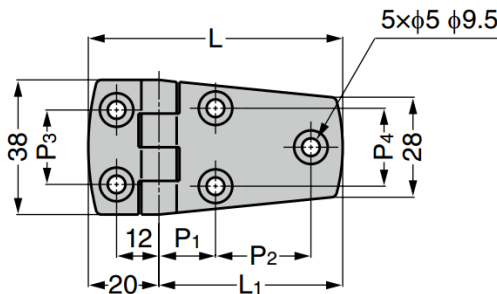

Part No.	L	L <sub>1</sub>	L <sub>2</sub>	P <sub>1</sub>	P <sub>2</sub>	P <sub>3</sub>	P <sub>4</sub>	Door Width	Door Height	Door Thickness	Load Capacity (per pair)	
G27900	58	38	42	13.5	16.5	21	20	Max. 450	Max. 700	Max. 21	167 N	17 kg
G27800	72	52	57	16	27	22	21					